



# **CENTRAL PARK**

r e s i d e n c e c l u b

TORRE 1 - BROOKLYN

rua paran, 196 - poços de caldas - mg

## CONHEÇA A TORRE 1 - BROKLYN

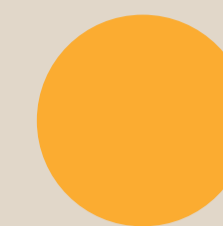

Torre 1 - Brooklyn



Torre 2 - Chelsea



Torre 3 - Soho





**LIVING FINAL 5**

perspectiva ilustrada do living final 5



**TERRAÇO FINAL 5**

perspectiva ilustrada do terraço final 5

**FINAL 1 - 59,40M<sup>2</sup>**

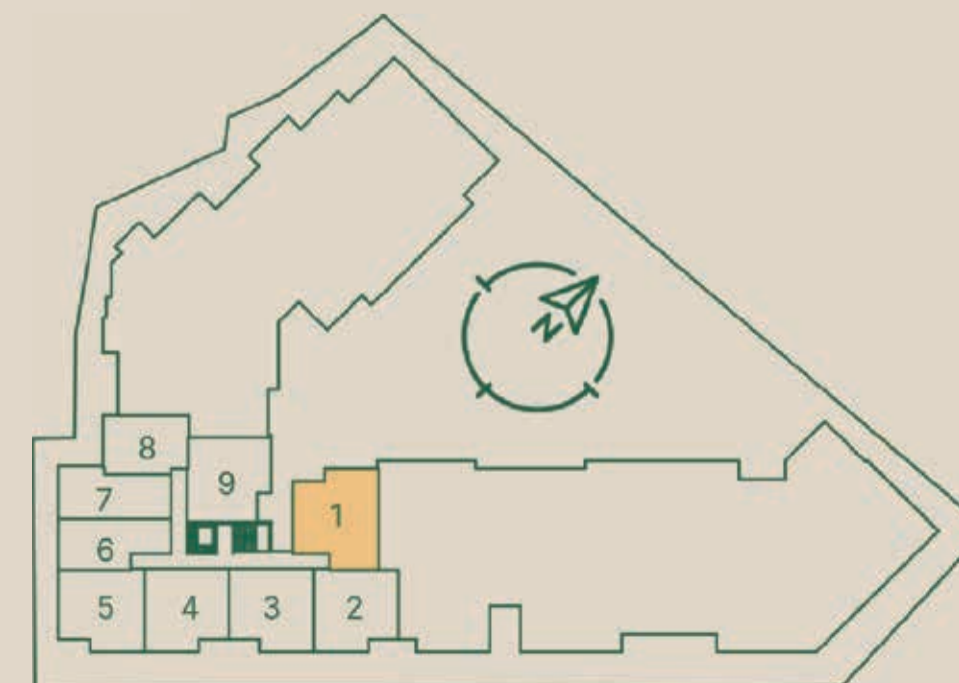

FINAL 2 - 50,40M<sup>2</sup>

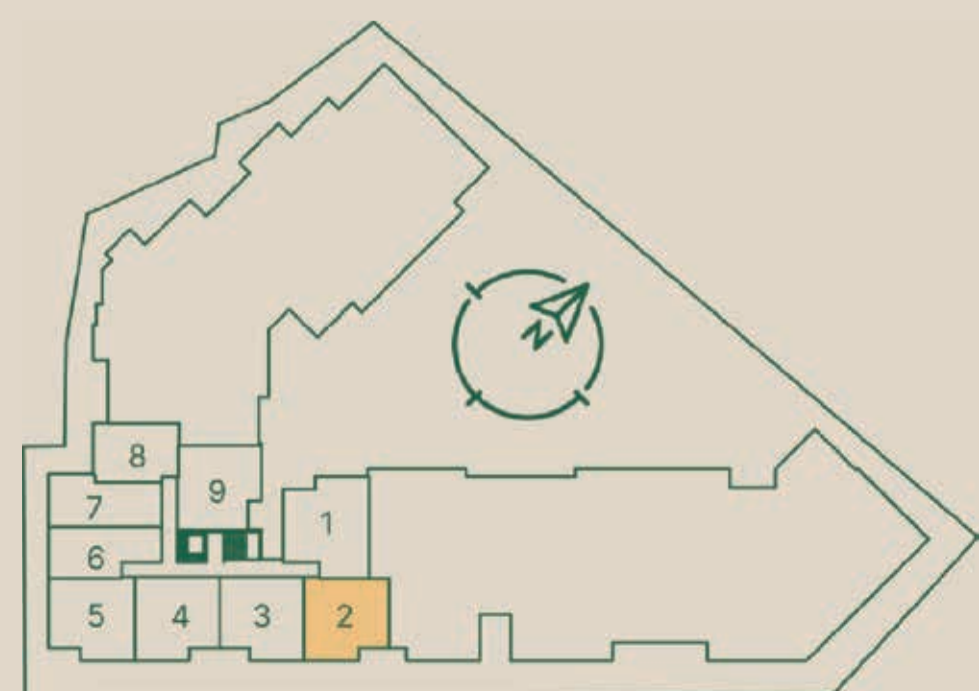

FINAL 3 - 51M<sup>2</sup>

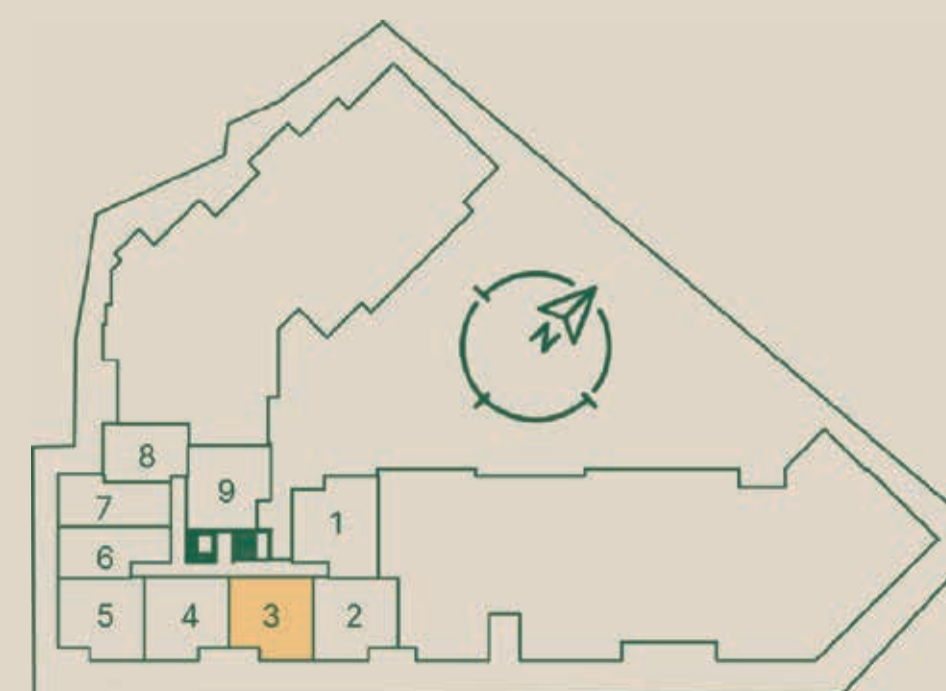

FINAL 4 - 51M<sup>2</sup>

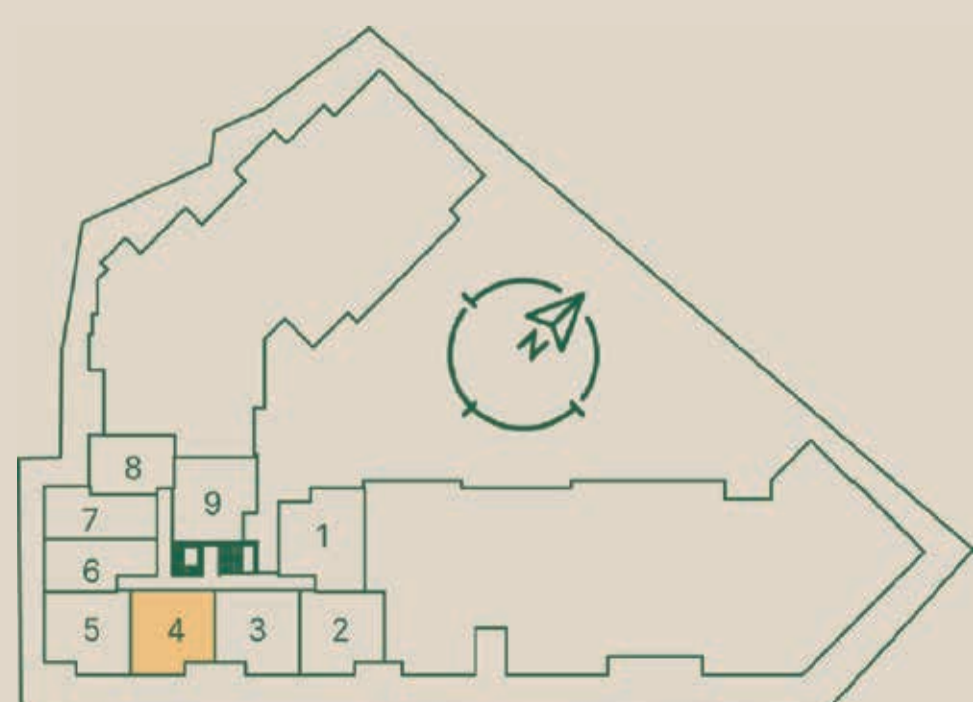

FINAL 5 - 51M<sup>2</sup>

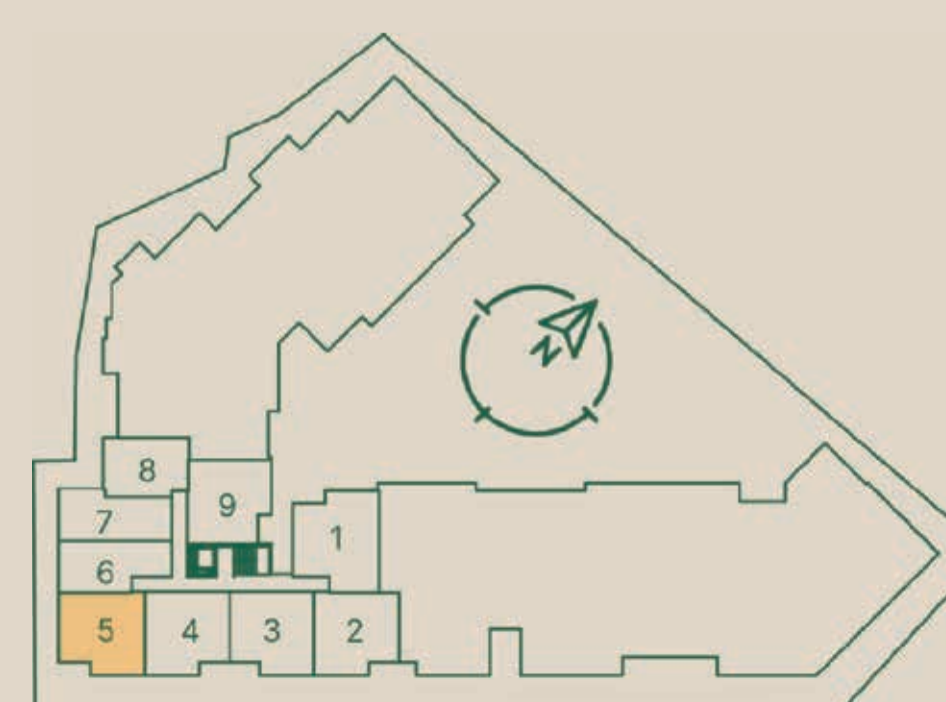

**FINAL 6, 2º PAVIMENTO - 44,60M<sup>2</sup>**

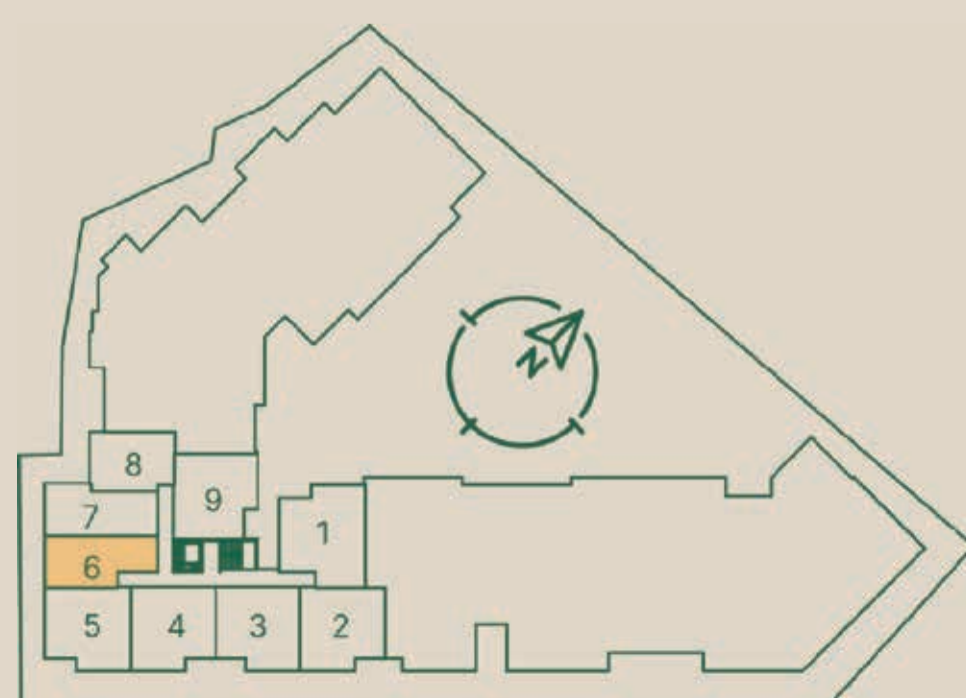

**FINAL 6 - 3º E 4º PAVIMENTO - 39,40M<sup>2</sup>**

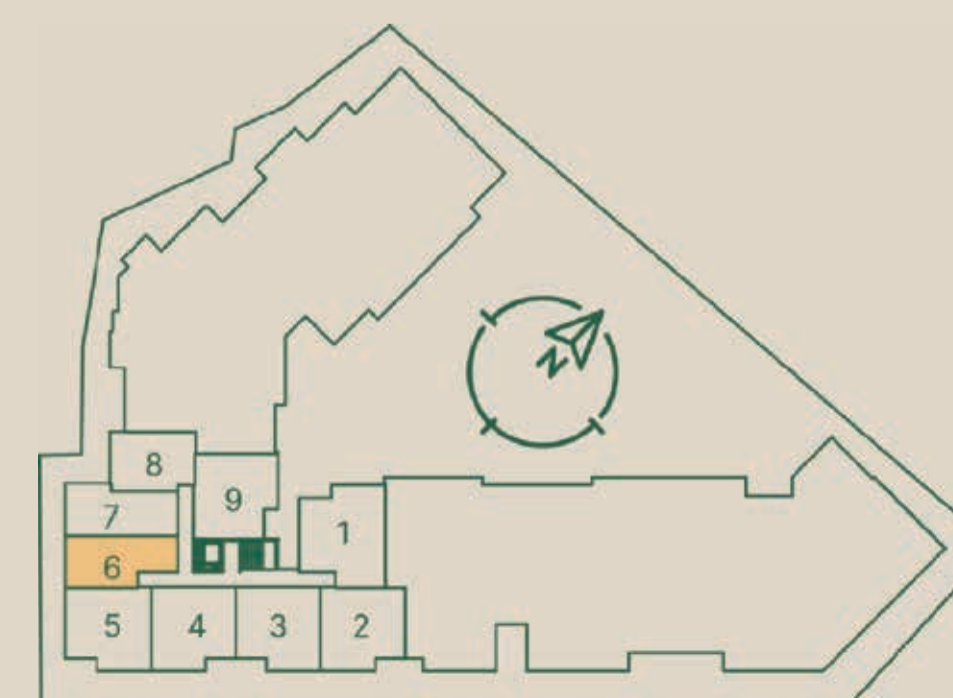

FINAL 7 - 41,35M<sup>2</sup>

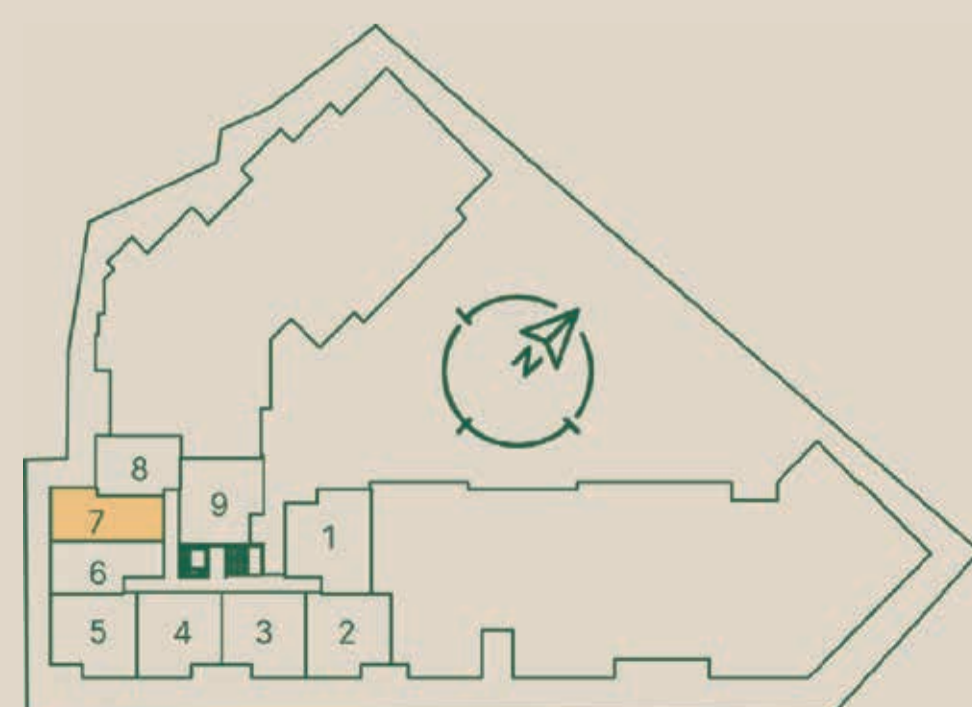

FINAL 8 - 37,30M<sup>2</sup>

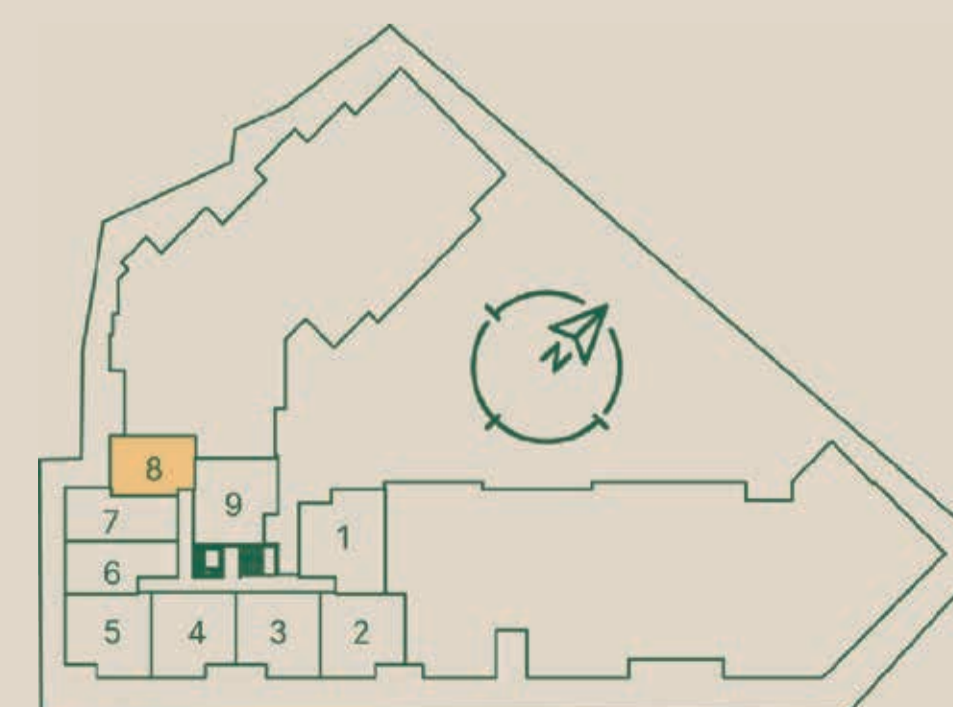

**FINAL 9 - 52,40M<sup>2</sup>**

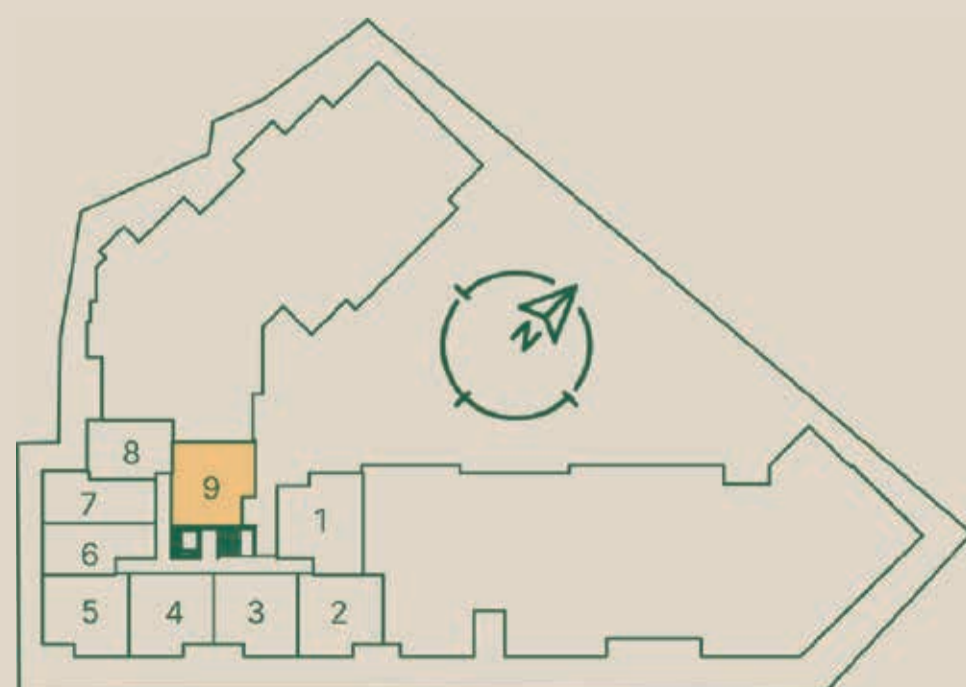

**DUPLEX FINAL 1 - 111,80M<sup>2</sup>**



**DUPLEX INFERIOR**



**DUPLEX SUPERIOR**

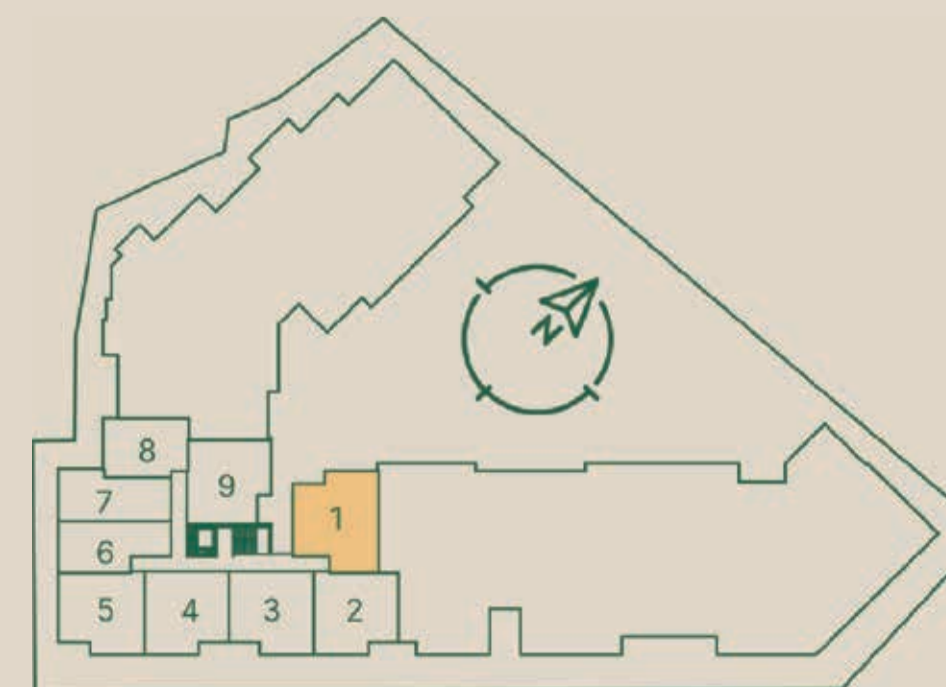



**DUPLEX FINAL 2 - 96,60M<sup>2</sup>**



**DUPLEX INFERIOR**

**DUPLEX FINAL 3 - 97,20M<sup>2</sup>**



**DUPLEX INFERIOR**



**DUPLEX SUPERIOR**

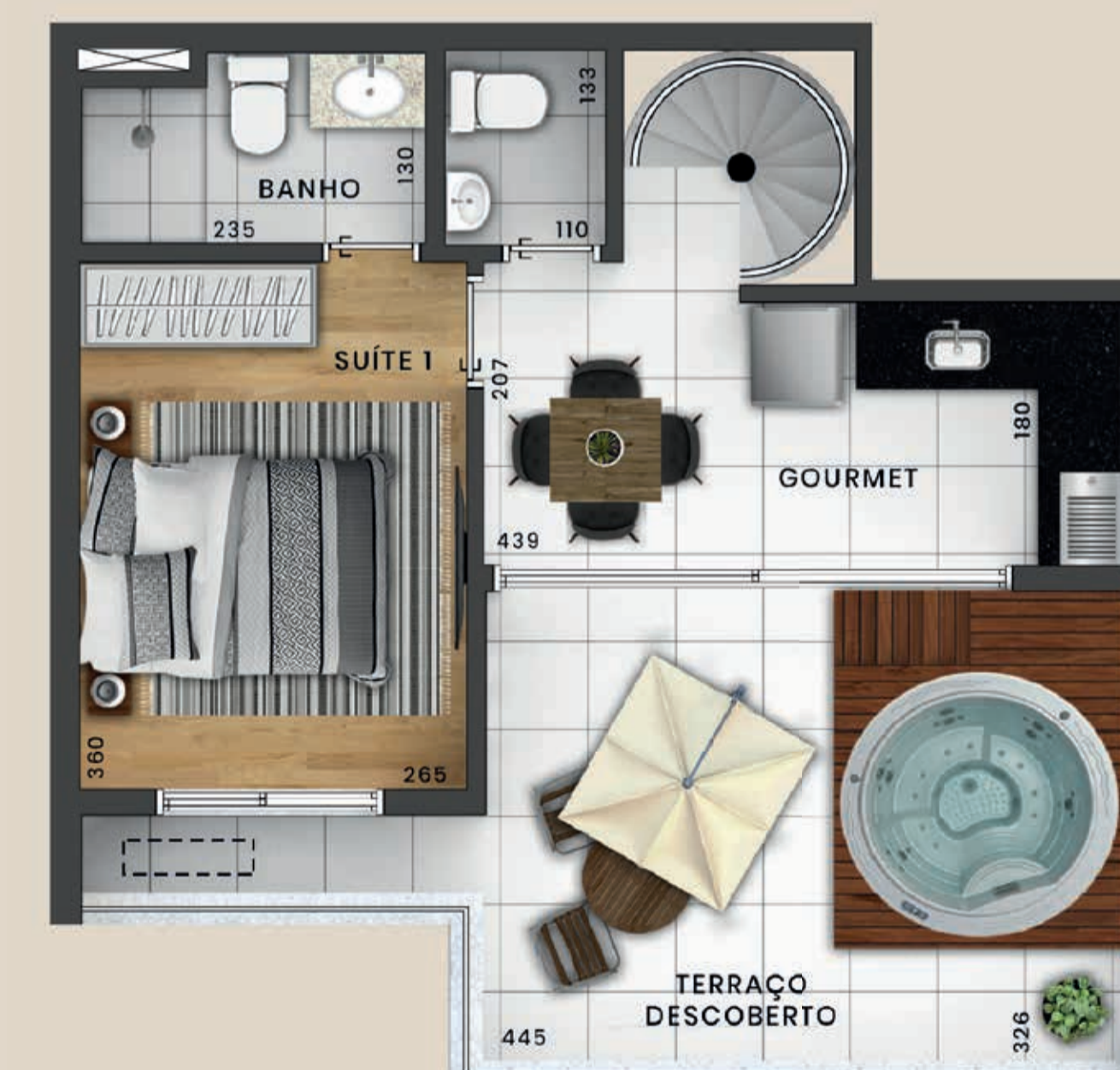
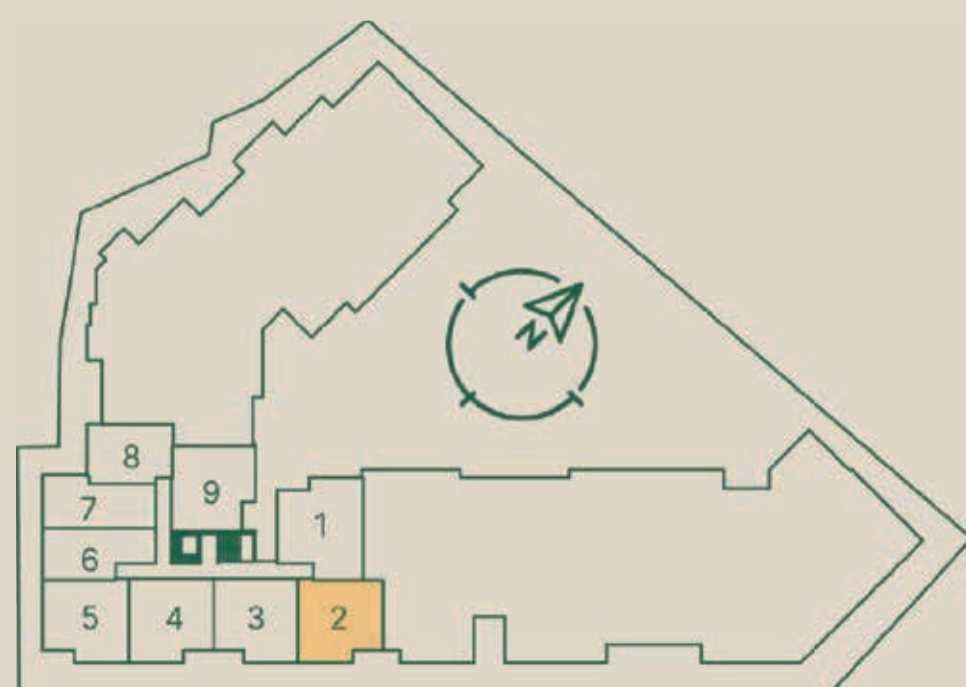

**DUPLEX SUPERIOR**

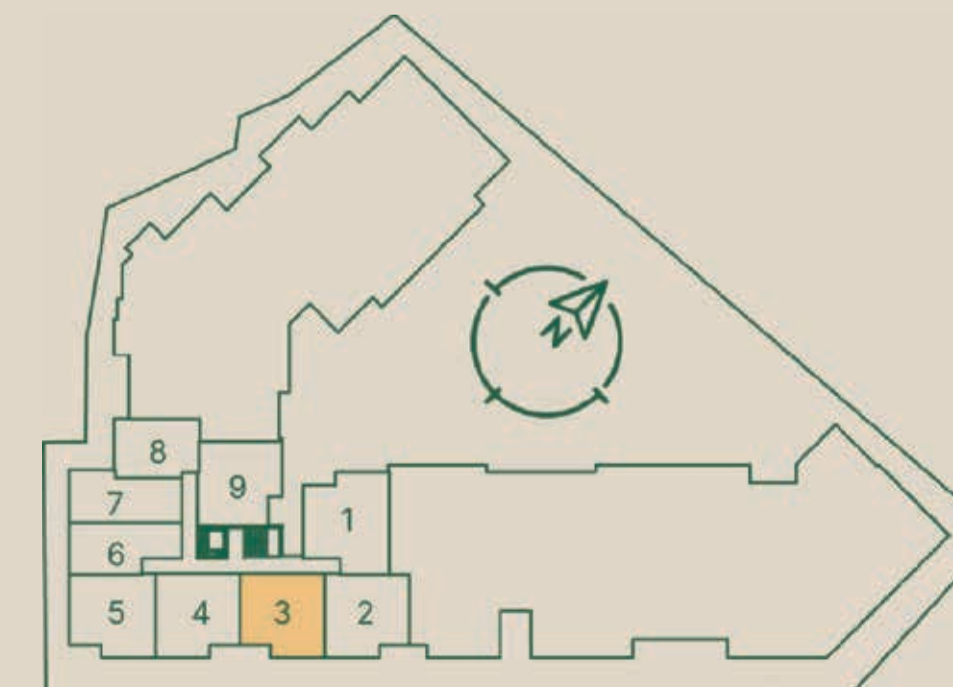

**DUPLEX FINAL 4 - 97,20M<sup>2</sup>**



**DUPLEX INFERIOR**

**DUPLEX FINAL 5 - 97,20M<sup>2</sup>**



**DUPLEX INFERIOR**

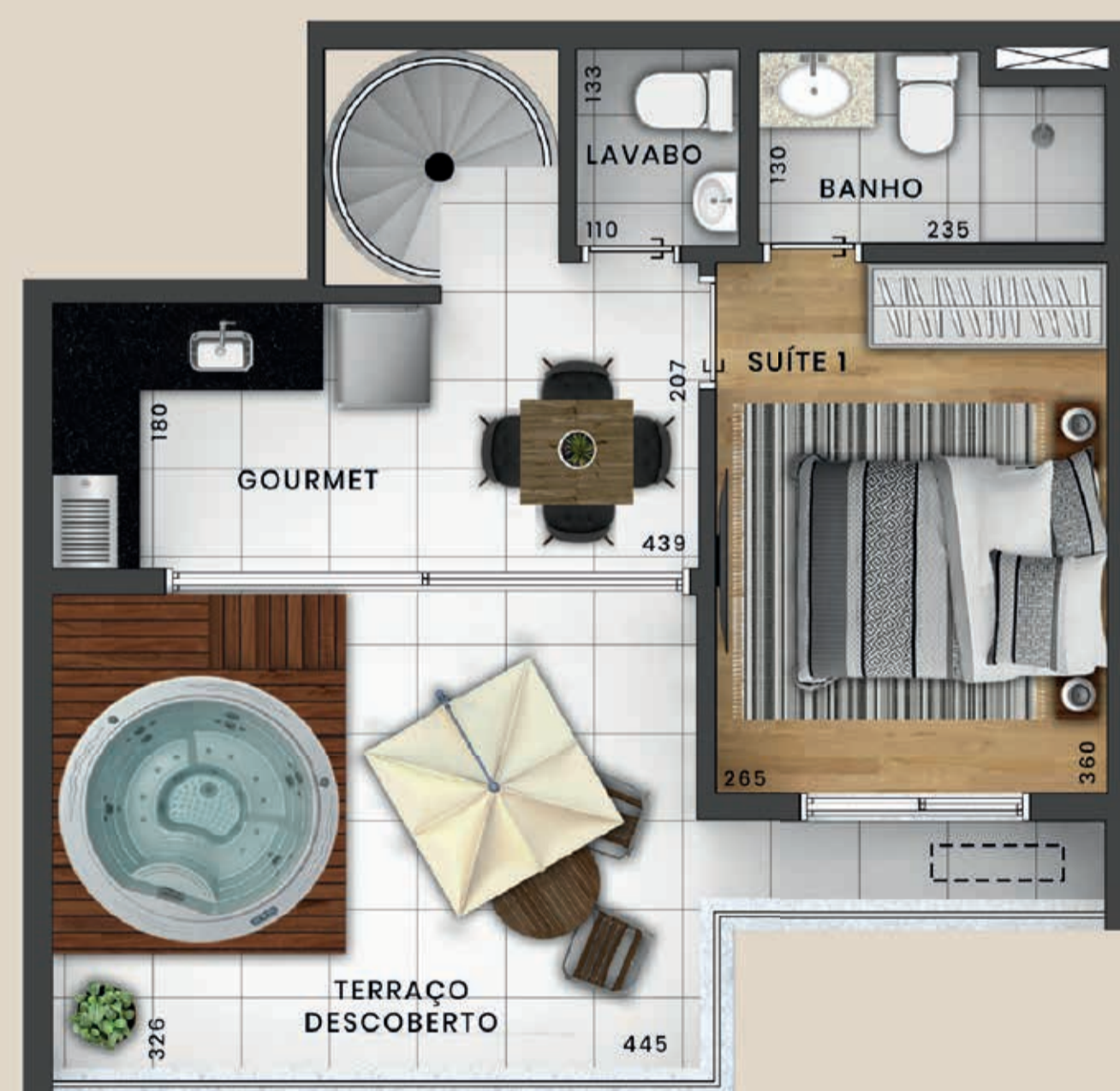

**DUPLEX SUPERIOR**

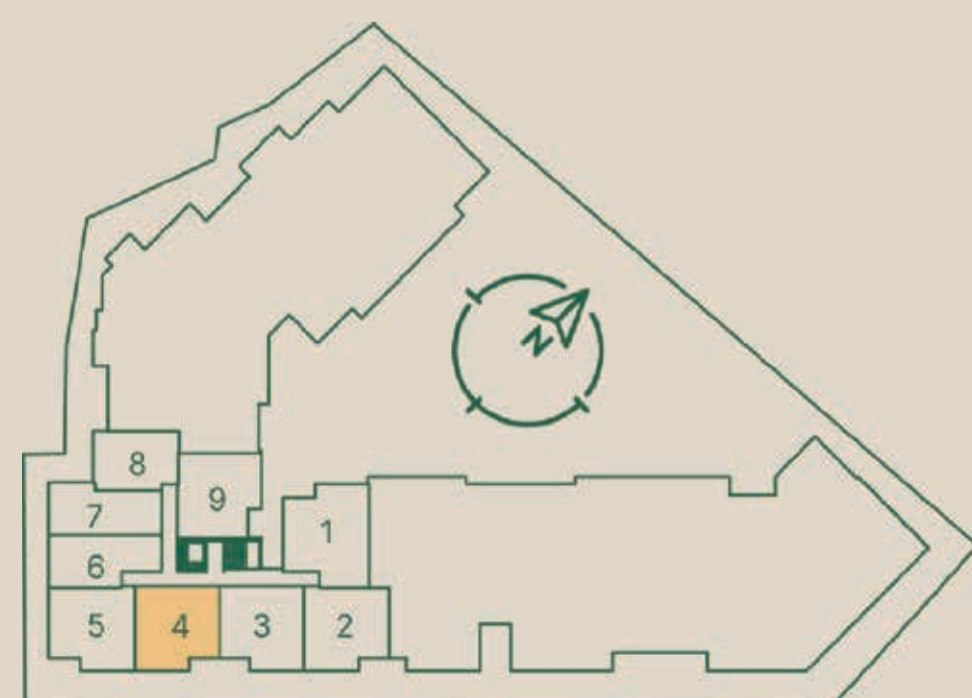

**DUPLEX SUPERIOR**

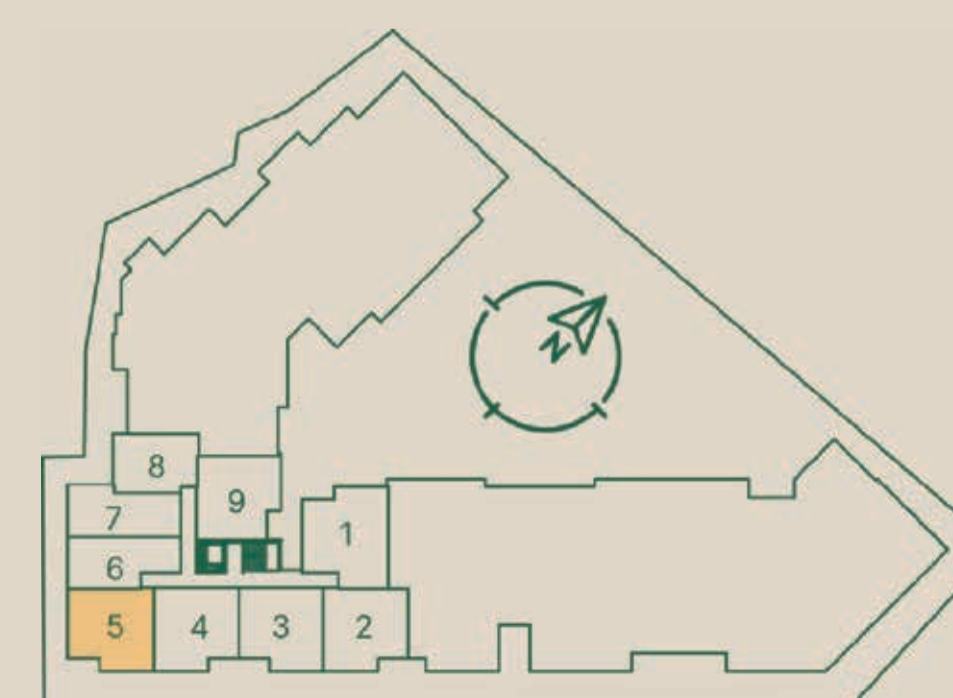

**LOFT FINAL 6 - 64,45M<sup>2</sup>**

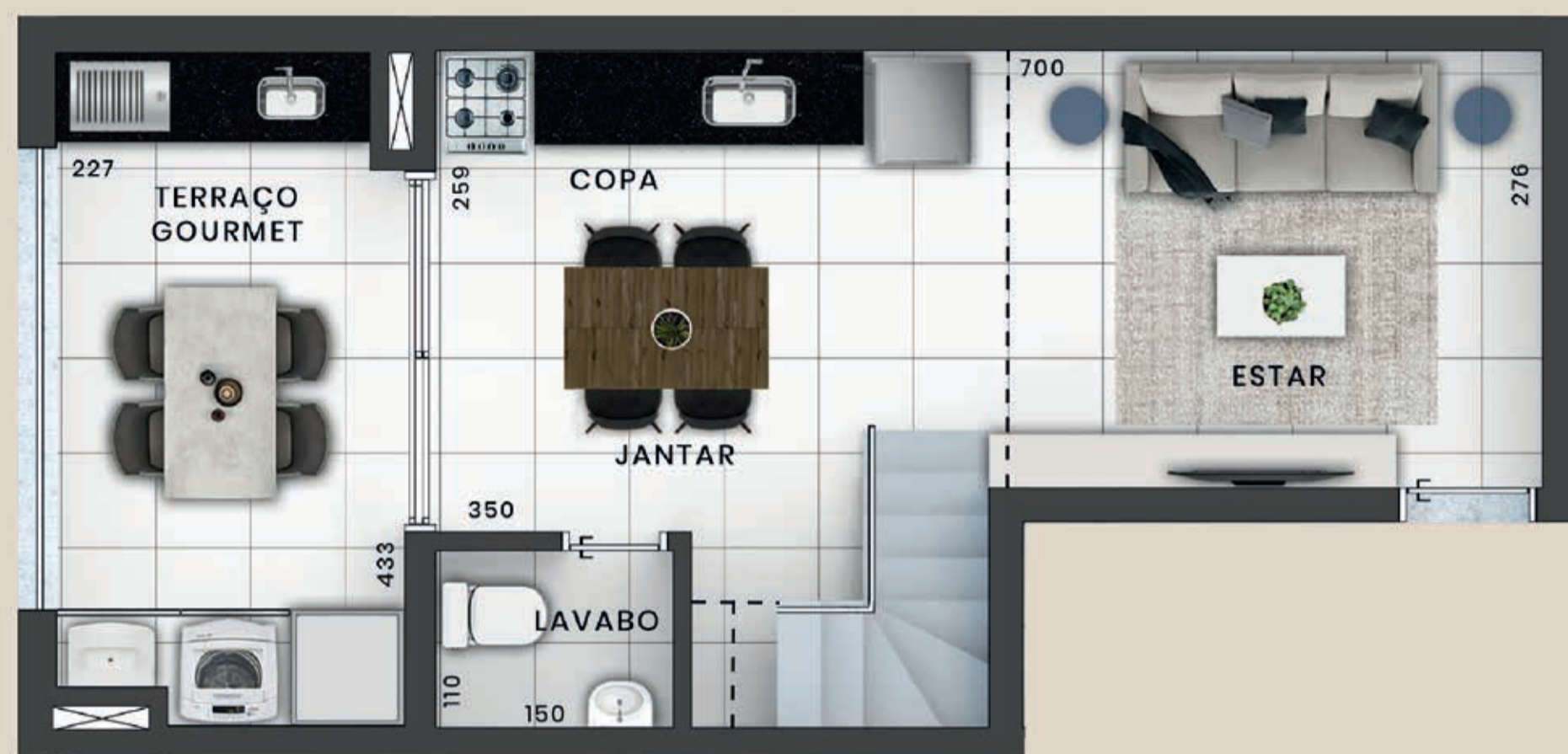

**DUPLEX INFERIOR**



**DUPLEX SUPERIOR**

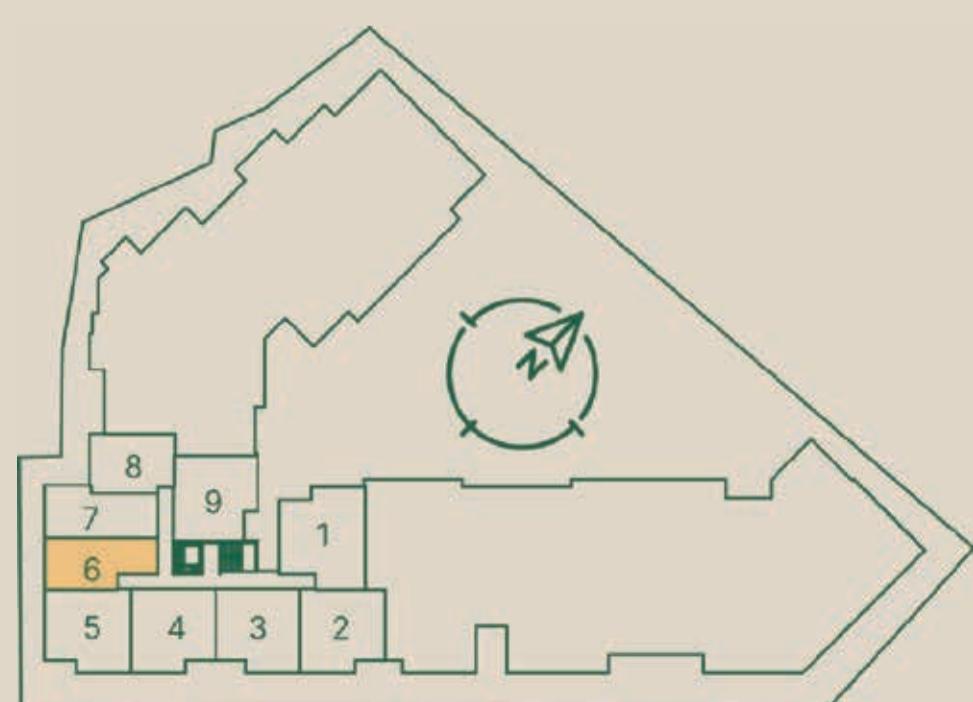

**LOFT FINAL 7 - 69,65M<sup>2</sup>**

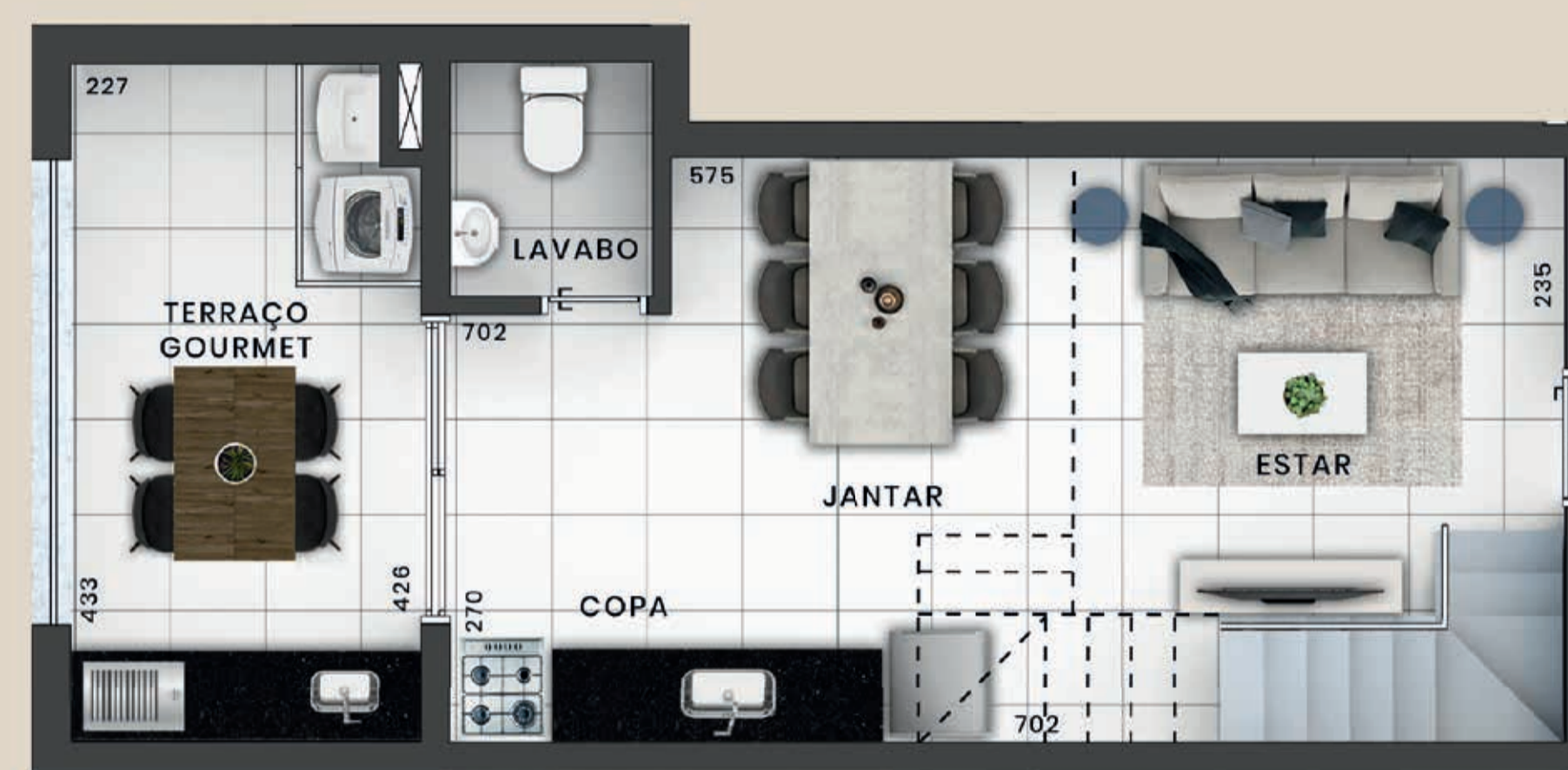

**DUPLEX INFERIOR**



**DUPLEX SUPERIOR**

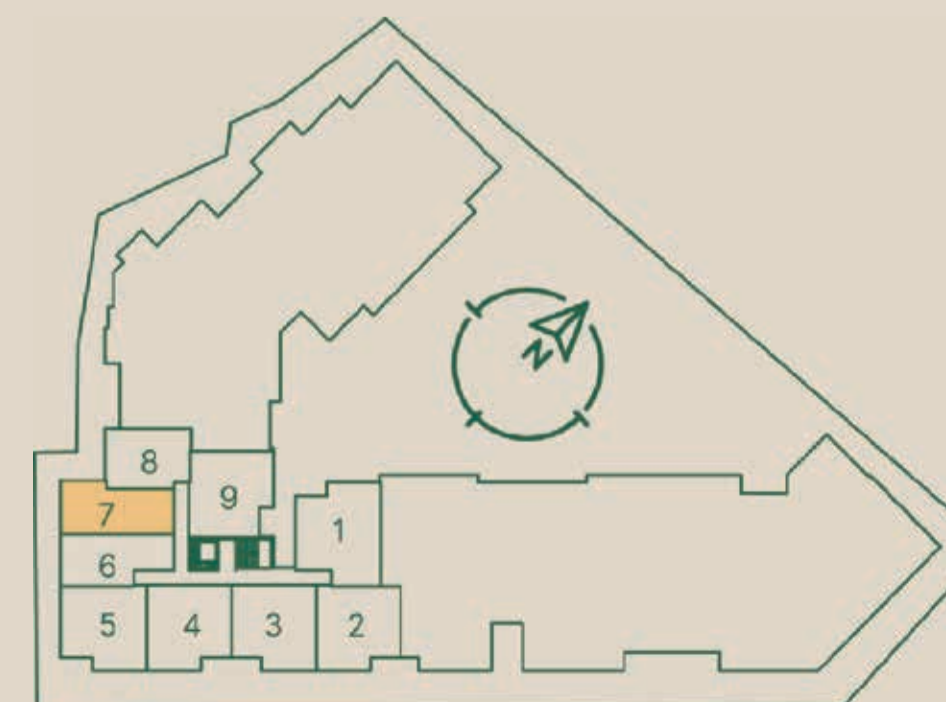

**LOFT FINAL 8 - 61,45M<sup>2</sup>**



**DUPLEX INFERIOR**



**DUPLEX INFERIOR**



**DUPLEX SUPERIOR**



**DUPLEX SUPERIOR**

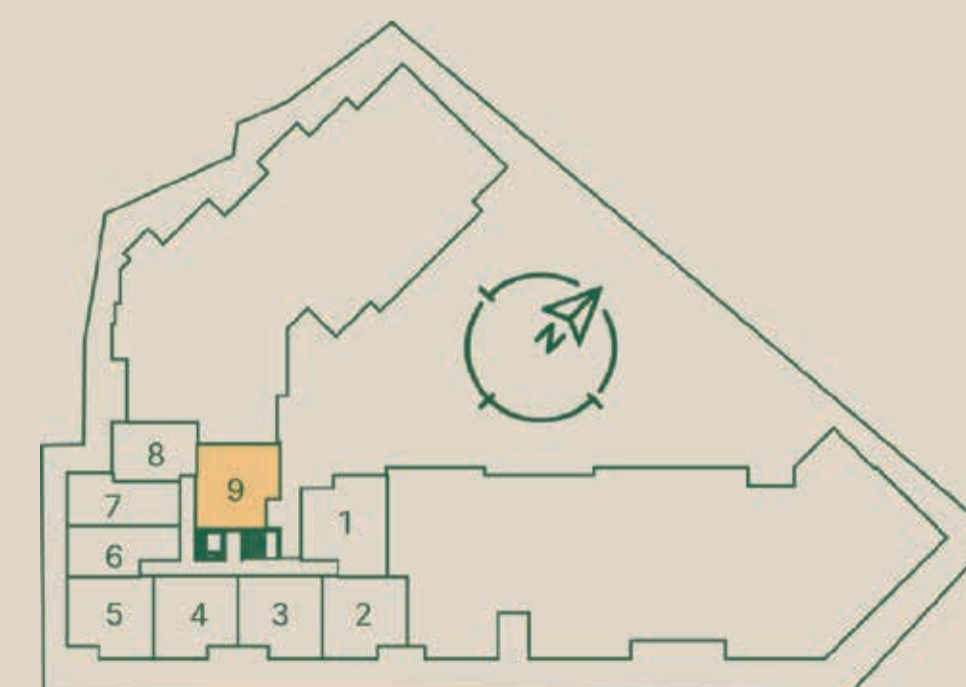
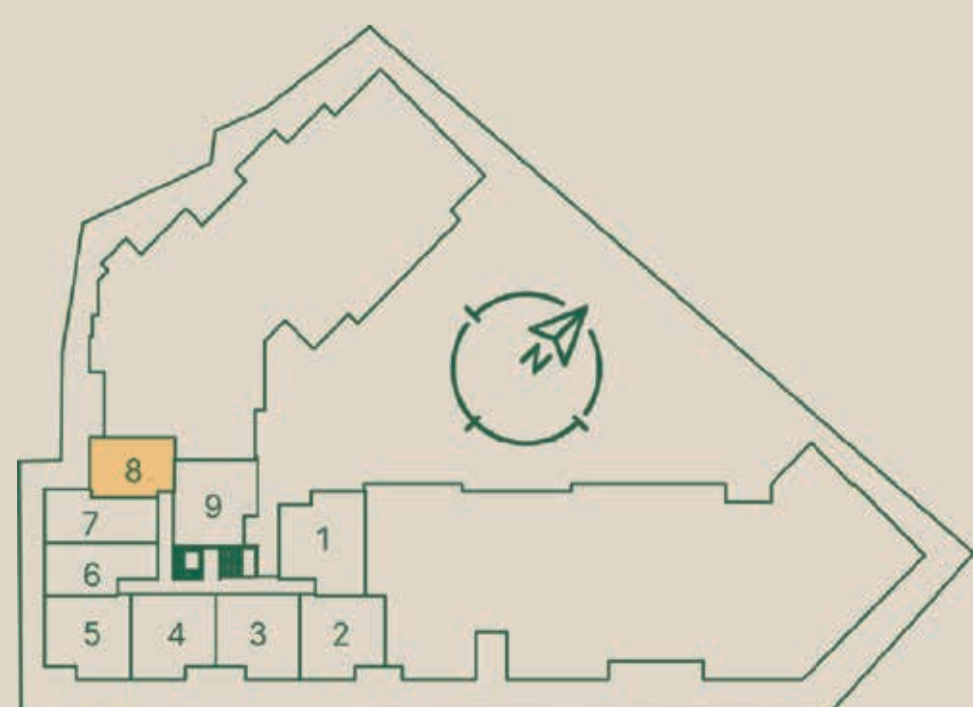

## LIVING DUPLEX FINAL 5

perspectiva ilustrada do living livin duplex final



## LOFT FINAL 7

perspectiva ilustrada do loft final 7



## TERRAÇO DUPLEX FINAL 5

perspectiva ilustrada do terraço duplex final 5



**CENTRAL PARK**  
residence club

incorporação e construção

**MUNIZ**  
INCORPORADORA

[www.munizincorporadora.com.br](http://www.munizincorporadora.com.br)

”As perspectivas e plantas são ilustrativas e possuem sugestão de decoração. Os móveis e utensílios são de dimensões comerciais e não fazem parte do contrato. Projeto aprovado pela SEPLAN da prefeitura de Poços de Caldas- MG em 22/03/2022. Alvará N° 161/2022 sob protocolo N° 0067258-048/2021 .Engenheiro responsável pela obra: Paulo Henrique Muniz Silva, CREA: 176435/D, ART N°: 20210003171. O empreendimento só será comercializado após o registro do memorial de incorporação junto ao cartório competente.”